

EXHIBIT D - FIFTH ADDITON TO WESTLAWN ESTATES

QUAM ENGINEERING, LLC 4604 Siggelkow Road, Suite A - McFarland, WI 53558 (608) 838-7750 \HC-06-19\HC06BASE.DWG

UTILITY NOTES:
 1. SANITARY MANHOLE PLUG SHALL BE INSTALLED IN THE DOWNSTREAM MANHOLE IN THE OUTLET PIPE UNTIL THE PROJECT HAS BEEN ACCEPTED. THE PLUG MUST BE INSTALLED IN THE PRESENCE OF THE ENGINEER AND MAY BE REMOVED ONLY IN THE PRESENCE OF THE ENGINEER. WATER THAT HAS ACCUMULATED IN THE DOWNSTREAM MANHOLE MUST BE PUMPED OUT PRIOR TO REMOVAL OF THE PLUG.

- SANITARY MANHOLE
- SANITARY PIPE
- SANITARY FORCE MAIN
- ⊕ PROPOSED HYDRANT
- ⊕ PROPOSED WATER VALVE/CURB STOP
- PROPOSED WATER PIPE
- PROPOSED STORM SEWER INLET
- PROPOSED STORM SEWER MANHOLE
- PROPOSED STORM SEWER PIPE

- PHASE 1 (19 LOTS)
- PHASE 2 (13 LOTS)
- PHASE 3 (16 LOTS)
- PHASE 4 (13 LOTS)
- PHASE 5 (21 LOTS)
- PHASE 6 (18 LOTS)

GRAVITY SEWERED LOTS (PHASES 1 - 4)
 # OF LOTS = 61
 COMPRISED LOTS:
 380-392,
 400,
 404-416,
 436-479

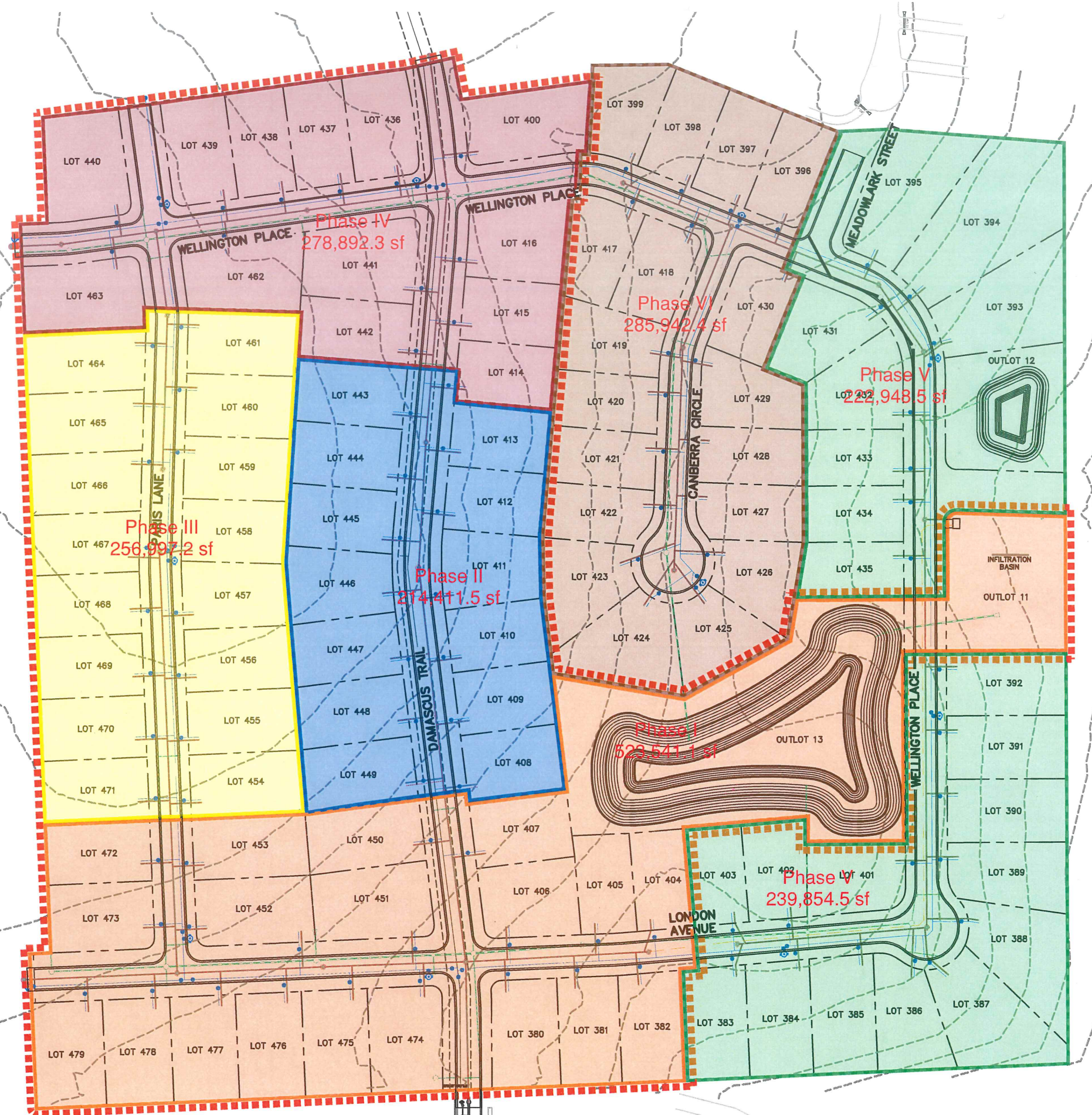
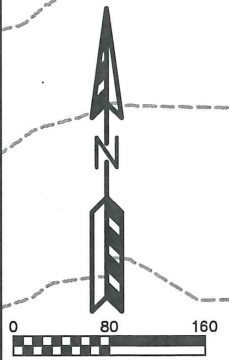

FIFTH ADDITION TO WESTLAWN ESTATES
 OVERALL UTILITY AND PHASING PLAN
 PAGE: 4 OF 25
 DATED: NOVEMBER 7, 2019

QUAM ENGINEERING, LLC
 Residential and Commercial Site Design Consultants

www.quamengineering.com
 4604 Siggelkow Road, Suite A - McFarland, Wisconsin 53558
 Phone (608) 838-7750; Fax (608) 838-7752